

Central  
pavilion

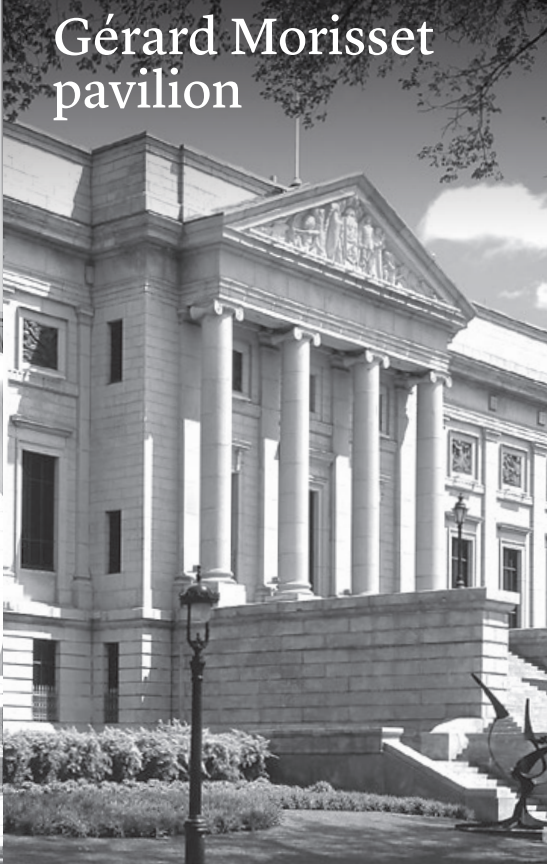

Gérard Morisset  
pavilion



Charles-Baillairgé  
pavilion



— B  
M —  
— A  
N —  
— Q

Musée national  
des beaux-arts  
du Québec

Québec 

National Battlefields Park  
Québec City QC G1R 5H3

Tel.: 418 646 9661

Toll-free: 1 866 220 2150

[locationdesalles@mnbaq.org](mailto:locationdesalles@mnbaq.org)

[mnbaq.org/yourevent](http://mnbaq.org/yourevent)

**MNBAQ**  
**.ORG**

# Central and Gérard Morisset pavilion

| ROOM                               | DIMENSION<br>M <sup>2</sup> /FT <sup>2</sup> | SET-UP |              |        |    |           |          |
|------------------------------------|--|--------|--------------|--------|----|-----------|----------|
|                                    |  | SCHOOL | THEATER      | SQUARE | U  | BANQUET 8 | COCKTAIL |
|                                    |  |        |              |        |    |           |          |
| CENTRAL HALL                       | 356 / 3 828'                                 | 250    | 275          | -      | -  | 216       | 500      |
| SALLE MULTI                        | 200 / 2 148'                                 | 100    | 174 (GRADIN) | 60     | 34 | 136       | 270      |
| CENTRAL HALL AND SALLE MULTI COMBO | 705 / 7 560'                                 | -      | -            | -      | -  | 352       | 670      |
| ROTONDE                            | -  | -      | -            | -      | -  | -         | 80       |
| SALON PAUL-RAINVILLE               | 90.6 / 975'                                  | 44     | 70           | 32     | 30 | 56        | 100      |
| JARDIN PELLAN                      | 201.7 / 2 171'                               | -      | 70           | -      | -  | 56        | 120      |
| TERRACE                            | 729 / 7 846'                                 | -      | -            | -      | -  | 400       | 800      |

# Charles-Baillaigé pavilion

|   |              |    |    |    |    |    |     |
|---|--------------|----|----|----|----|----|-----|
| ATRIUM BANQUE NATIONALE<br>ET SES 4 ÉTAGES      | 460 / 4 952' | -  | -  | -  | -  | -  | 250 |
| ATRIUM BANQUE NATIONALE,<br>OPTION SUR UN ÉTAGE | -            | -  | -  | -  | -  | -  | 75  |
| SALLE DE RÉUNION                                | 105 / 1 120' | 32 | 60 | 30 | 24 | 40 | -   |
| SALLE DU CONSEIL                                | 49.6 / 534'  | -  | -  | 16 | -  | -  | -   |

## Central and Gérard Morisset pavilion

LEVEL 0

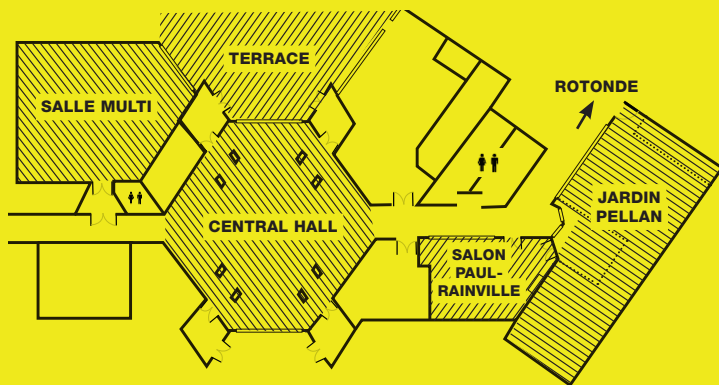

## Charles-Baillaigé pavilion

LEVEL 0

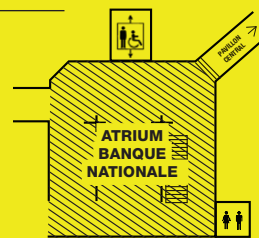

LEVEL 1

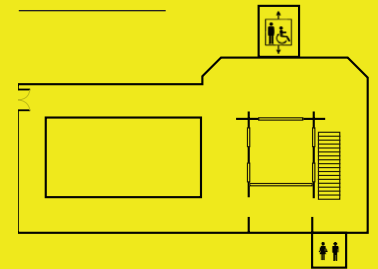

LEVEL 2

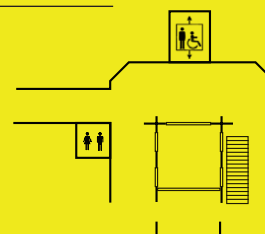

LEVEL 3

